

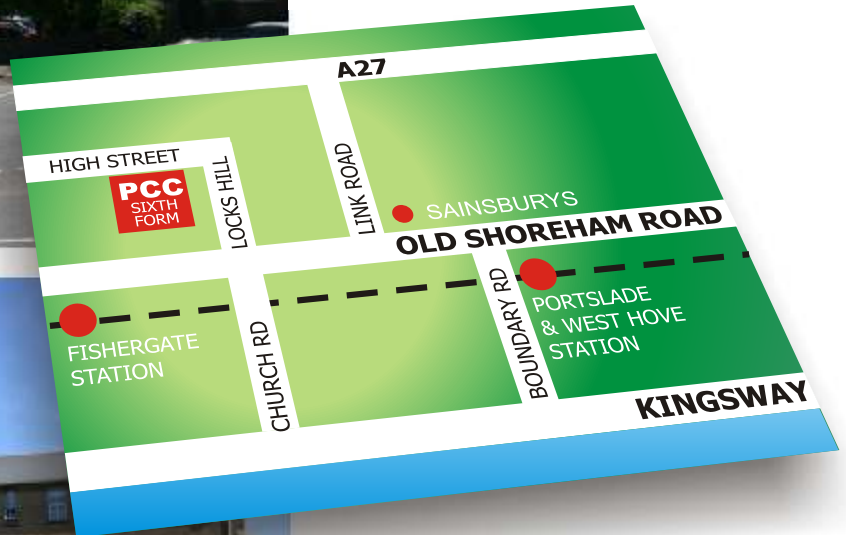

PCC FORM
PORTSLADE COMMUNITY COLLEGE CARING FOR ACHIEVEMENT
PROSPECTUS



A lively learning community situated just north of The Old Shoreham Road in Portslade Old Village. Buses 1 and 1A serve the area on a regular basis.

PCC **6** FORM

PORTSLADE COMMUNITY COLLEGE CARING FOR ACHIEVEMENT

Portslade Community College
Sixth Form Centre
High Street
Portslade
Brighton BN41 2PG

T: 01273 410711
F: 01273 417986

E: 6th@pcc-web.com
W: www.pcc-web.com/6th

Introducing the Sixth Form

The 6th Form Centre on the College's High Street site offers high quality education for the full range of academic and vocational courses. We provide a friendly and hard-working environment organised entirely for the needs of 6th Form and adult students.

The Centre has a base for each subject, including Science laboratories, as well as social facilities in the Common Room and Hall, organised by the SWAG (Student Council). There is a superb computer network of 100 workstations, with free internet access, as well as digital photography, video-editing and a large number of interactive white boards.

The Centre teaches up to 175 students. Class sizes are small, twelve on average. Teaching methods are up to date, stimulating and successful and learning is seen as a partnership. Students enjoy many opportunities for showing leadership, contributing in the community, drama, music and sports activities encouraged.

Academic results are excellent: the A Level pass rate from 2001 to 2009 is over 90%, each year and students achieve an average half grade higher in each A Level they take above their prediction on the ALIS system. Please note that classes need a minimum number to be viable.

Students have the support of a personal tutor. They work together on study skills, and prepare carefully for University or employment. Most of our students go on to Higher Education, and the College has a progression agreement with our local Universities. The Centre is open to all students with suitable qualifications for the courses they wish to study, and who can show evidence of commitment.

The Year 2010-11 Prospectus will be available in September and interviews begin in November and December. You are welcome to visit at any time.

The Open Evening is on Wednesday October 21st 2009 from 5.00pm to 7.00 pm.

Join our success!!



Graham Steel

PCC FORM
Caring for achievement

Choosing Sixth Form Courses

A Levels are open to students with at least four or five GCSEs at grades A*-C. If you don't have these, you can study for OCR National Certificate for one year, which is the equivalent of four GCSEs. This can also be combined with GCSE Maths and English and ECDL in ICT. If you pass this with Merit or Distinction you can study Advanced Levels for the following two years. Many students do this each year.

A Levels can be chosen more freely than you might think. You do need good GCSEs in Maths, English, Languages and Science to continue these subjects at A Level. Most other subjects don't require any particular GCSEs: good news if you've changed your mind since choosing options for GCSE. A few careers such as medicine and architecture require specific A Levels, but most don't - including law, teaching, business and media. Therefore you should choose subjects you enjoy and will get high grades in.

Traditionally, 6th Formers choose three A Levels. The government is now encouraging students to take up to five in the first year (Lower 6th or Year 12) leading to the AS Level exams. You might then continue three of these through to A Level at the end of the second year (Upper 6th or Year 13). A good compromise might be to choose three traditional subjects and one or two of the 'Additional' subjects which are less demanding in terms of attending classes and learning, because they can be linked to your other courses. Vocational courses can be mixed with traditional A Levels. These are more coursework or practically based and introduce you to an area of employment. These also include work placements.

The full prospectus will help you choose, followed by the Open Evening in October. Interviews with the Head of Centre in November and December provide a chance to talk in detail. You can attend a class if you wish. There is an Introductory Day in late June after GCSEs. In September 2010, you will have your GCSE results and make your final decision on courses with your new 6th Form Tutor. See you soon!

Tutors and Personal Development Courses

Study Skills and Personal Development

Tutors help the students learn how to work independently which is required at this level. They also help students to manage their time effectively. This prepares students to take responsibility for their own lives when they enter Higher Education and employment. Tutors and invited speakers also teach issues related to Health, Society and Citizenship. In Year 13 students are prepared for practice interviews, with debriefings, by local employers. There are regular individual tutorial sessions also

Citizenship

The course offers a progress route from Key Stage 4. During the course students will develop a broad understanding of Core Citizenship Concepts and how they can make a difference through participation in activities. Usually your tutor teaches this course. It is important to consider doing some Voluntary Work during your courses such as helping students in other institutions or joining the Sports Leaders Course

Vocational Experience and Voluntary Work

All students are encouraged to take part in Vocational Experience away from the College. National Certificate students generally have placements included in their course, either for one day a week or for longer periods. Students organise the placement with the help of tutors.

Careers

Our Connexions Careers Adviser is available for interviews and advice. Appointments can be made through the 6th Form Secretary. We also keep an up-to-date Careers Library at the 6th Form. A special themed day concentrates on careers and university applications.

Academic Diary

Students are encouraged to use their academic diary to record and plan their use of private study time. This helps students meet deadlines and work efficiently. Also students can keep a record of their targets and their progress towards them.

Themed Days

We also organize special days to teach students about health related issues and financial awareness.

Sixth Form Students

Relationships

6th Form education is a partnership between staff and students. It is not a one-way process of teacher talking and student listening. Students are encouraged to share responsibility for their learning by enthusiastic participation, intelligent discussion and careful preparation of their work.

Staff have the time to give a lot of individual help and students can feel confident to be open about what they find difficult.

Students also support each other. The 6th Form is a small and friendly environment. It is essential that all students trust each other and can work together. The Student Council (known as SWAG), elected by the student body, holds its own funds and has the role of organising events and advising on the running of the 6th Form Centre.

Students are strongly encouraged to participate in the extra-curricular life of the 6th Form, including sport, community activities, music and social events. Many visits to lectures, museums, University Open Days, and Careers Fairs are organised. For a few days each year, the whole 6th Form take part in Themed Days about areas not covered in the ordinary curriculum such as financial awareness and health issues.

Universities and employers are particularly interested in voluntary activities and responsibilities that students have undertaken, in addition to their normal studies. They ask for this information in references from the College.

Standards of Work

GCSE, National Certificate and A level courses are demanding, and public examinations are highly competitive. Students are required to complete all the work on their courses by the deadlines which are set. It is particularly important that major coursework assignments and projects are planned, started and completed in good time. Success in examinations also requires personal reading and research in addition to the specific work set by staff.

Programmes of Study for each course are posted home twice a year to keep students and parents well-informed of the work and styles of learning involved in studying at 6th Form.

Students should study for 40 hours each week, including classes, study time at College and homework. Part-time employment is often important to students: the recommended maximum is 10 hours. This should be reduced during assessments and final examinations.

The records of past students show that most high grades were achieved by students who were not in part-time work.

Sixth Form Students

Attendance

The 6th Form is like any other place of work, and requires that students attend all timetabled classes, meetings and interviews. Only the most serious difficulties justify absence. Students may not arrange outside appointments, including driving lessons during classes. Holidays should not be taken while the College is working: students considering taking a holiday must put their request in writing to the College Principal but it is advised not to take holidays in term and exam times.

On arrival each day, students read the notice board or consult the TV for information in case of room changes or to be informed of events.

Attendance is logged each lesson electronically and students who are missing are contacted as quickly as possible if they have not informed us beforehand.

A student who, through emergency, is unable to attend, must telephone the (410711 or 417986) before 9.00 in the morning. On their return to College the student gives the reason for absence. Students who are under 18 years need confirmation from their parents of the reasons for absence.

Unexplained absences could result in students leaving 6th Form. Details of absences are also required on most employers' reference requests to the College. Attendance figures are published half-termly and a £25 prize is awarded each term in a prize draw for all 6th Form students with full attendance that term.

Sixth Form Tutors

Manager

Tutors are responsible for monitoring student attendance, progress and relationships with staff and fellow students. They co-ordinate records and reports, and prepare references. They are the main point of contact for parents, and can be contacted via the Sixth Form Secretary (01273)410711.

Personal Support

Tutors will try to support students in coping with any decisions or difficulties that may arise.

They will also enjoy hearing about personal successes and achievements.

Group Teacher

Tutors teach the Personal Development Course each week, in tutor groups of twelve to fifteen students.

Head of Centre

Graham Steel

Head of Student Services

Sue Ryan
Marian Hackett
Ken Hughes (Examinations Officer)
Chris Kilsby
Jane Lane
Teresa Murphy
Val Bundy
Julia Proven

Secretary

Margaret McHugh

Mentors

Sally Cristin

Caretaker

Keith Wedd

IT Technician

Farhad Zadeh

Senior Science Technician

Ruth Beresford

Study Facilities

A level / GCSE courses require students to work on their own projects and coursework as well as homework. It is essential for students to read widely to obtain background knowledge in their study areas.

Reference and IT Facilities

There is a Reference Library in Room 1, including encyclopaedias, dictionaries and reference books for each course. There are desks for private study and students can also work at desks with PCs and CD Roms, available from 8.00am until late in the afternoon.

Subject Libraries

Many books available to students are kept in subject teaching rooms along with videos and other resources. Most of these can be borrowed.

College Library

All students can become members of the College Library on Chalky Road site. This library is shared with the public and provides a full public library range of services. Liz Morgan is the College Librarian.

Sports Centre

All students may use facilities by the Sports Centre at Chalky Road Some facilities may need prior booking and/or induction courses.

Kitchen

The kitchen is open 8.30am - 1.45pm for the sale of drinks and hot/cold food. A 'school meal' is also available. Students remain eligible for free meals: our Secretary will give you details.

Common Room

The running of the Common Room is shared with the Student Council (SWAG). Daily newspapers are available. SWAG also runs social facilities in the Hall, including pool table, table tennis and table football.

EMAs and Grants

Sixteen-year olds joining in September 2010 *are eligible* for EMAs. Local authorities give grants to older students whose families are in receipt of means-tested benefits. The 6th Form Secretary can give further details of these grants. You can also get help with one-off expenses such as field trips and University visits. Childcare costs can also be met.

Sixth Form Calendar 2009-2010

September 3rd, 4th, 7th

Interviews

Tuesday September 8th

Induction Day Assembly

Wednesday September 9th

Years 12 & 13 lessons begin

Thursday October 8th

Target Setting Day

Friday October 9th

Inset Day

Wednesday October 21st

Year 11's Open Evening at 6th Form 5-7pm

October 26 30th

Half Term

Monday November 2nd

Inset Day

November 16th 20th

Years 12 & 13 Assessment week 1

December 7th 11th

Health Week incl. Health Day Tues.8th

Wednesday December 9th

6th Form Reports to office and Tutor

Tuesday December 15th

6th Form Reports posted home

Thursday December 17th

6th Form Certificate Evening

Friday December 18th

End of Term

YEAR 2010

Monday January 4th

Term begins

Thursday January 7th

6th Form Parents Consultation Evening

February 1st - 4th

European Science Study Experience - Paris

Wednesday February 10th

Moving On Day - Years 12 & 13

February 15th 19th

Half Term

Monday March 1st

Years 12 & 13 Assessment Week 2

Tuesday March 2nd

Inset Day

March 30th

Easter Holiday

March 31st

Inset Day

April 19th

Summer Term Begins

May 31st June 4th

Half Term

Monday June 7th

Year 12 A2 classes begin

Friday June 25th

6th Form Introductory Day Year 11

Tuesday June 29th

Year 10 What's Next? Visit to 6th Form

Wednesday June 30th

Year 10 What's Next? Visit to 6th Form

Thursday July 8th

6th Form Activities Day

Friday July 16th

Thorpe Park (to be confirmed)

Friday July 23rd

Term Ends

Sixth Form Code

This is read and signed by all students

- 1.** I understand that I will work to the best of my ability to complete the courses I have chosen, and to meet the work deadlines set.
- 2.** I understand that I will attend all time-tabled classes, for minimum of 15 hours per week, and other events the College requires me to attend. I understand that course changes must be made by October 5th.
- 3.** I understand that any absence will be accompanied by a courtesy call to the Office early on the day of absence. Telephone: 01273 410711 or 417986. I will not be absent except for unavoidable reasons and illness. I will provide a reason for my absence, in writing, on my return to College.
- 4.** I understand that I must be punctual and give reasons for lateness in an appropriate manner.
- 5.** I understand that College is a place of work, and that I must behave in a way which respects the rights of others and which is courteous and safe.
- 6.** I understand that College is a partnership between students and staff, and that we will try to resolve differences in a calm and constructive way, but that steps will be taken where there is a failure to maintain the 6th Form Code.

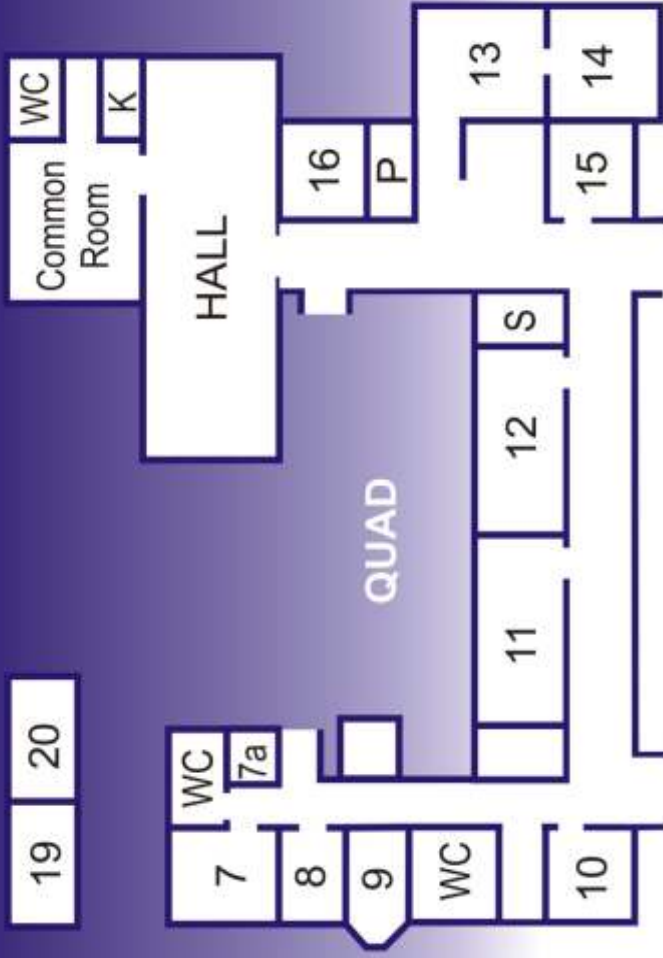

MAIN ENTRANCE AND CAR PARK

KEY TO ROOMS

1. Study Room
2. Health & Social Care
3. Media Studies
4. Biology/ Chemistry
5. Physics
6. Art
7. ICT
- 7a Tutorial Room
8. Humanities
9. Mathematics / Law
10. Psychology / Sociology
11. English / Film studies
12. Photography / Sport
13. Business
14. Business / Travel
15. Community Education

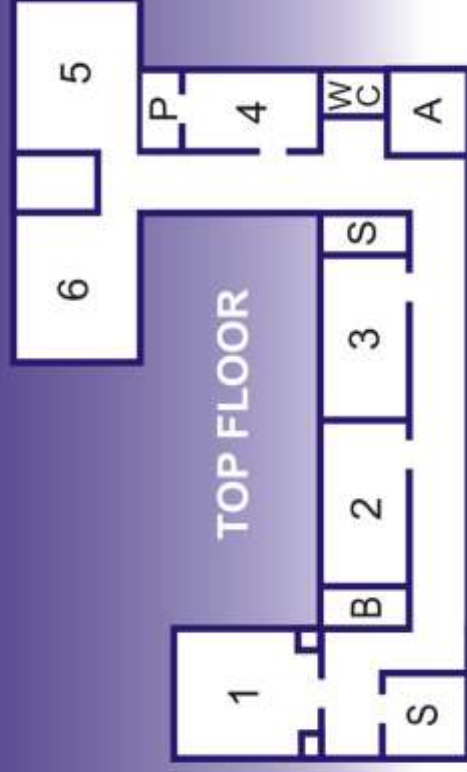

TOP FLOOR

PCCFORM

SIXTH FORM CENTRE
High Street Portslade BN41 2PG

Telephone: 01273 410711

Fax: 01273 417986

Email: 6th@pcc-web.com

Website: www.pcc-web.com/6th

16. Modern Languages
- 19/20. Com Education
- A. Head of Centre
- B. Senior Tutor
(Student Services)
- K. Kitchen
- P. Science Prep Rooms
- S. Staff Office

SIXTH FORM COURSES

THE SCIENCES	Biology	AS + A2
	Chemistry	AS + A2
	Physics	AS + A2
HEALTH AND SOCIAL CARE	Health and Social Care	AS + A2
	Health and Social Care Children's Care, Learning and Development	OCR Nat. Cert Lev.2 NVQ
LANGUAGES	French	AS + A2
	Spanish	AS + A2
MATHS	Maths/Further Maths	AS + A2
	Maths	GCSE
ENGLISH MEDIA	English Literature	AS + A2
	English	GCSE
	Film Studies	AS
	Media	AS + A2
ARTS AND TECHNOLOGY	Art	AS + A2
	Design Technology	AS + A2
	ICT	AS + A2
	ICT ECDL	Nat. Cert
	Performing Arts	AS + A2
	Textile Art	AS + A2
	Photography	AS + A2
	BUSINESS	Business Studies
	Business	OCR Nat.Cert.Lev.2
	Travel and Tourism	AS + A2
SPORT	Sport	Nat. Cert. Level 3
	Community Sports Leadership	
HUMANITIES AND SOCIAL SCIENCES	Geography	AS + A2
	History	AS + A2
	Law	AS + A2
	Psychology	AS + A2
	Sociology	AS + A2
ADDITIONAL COURSES	Critical Thinking	AS
	General Studies	AS + A2
	Hairdressing	NVQ

Plus courses offered in the Community Education Programme